

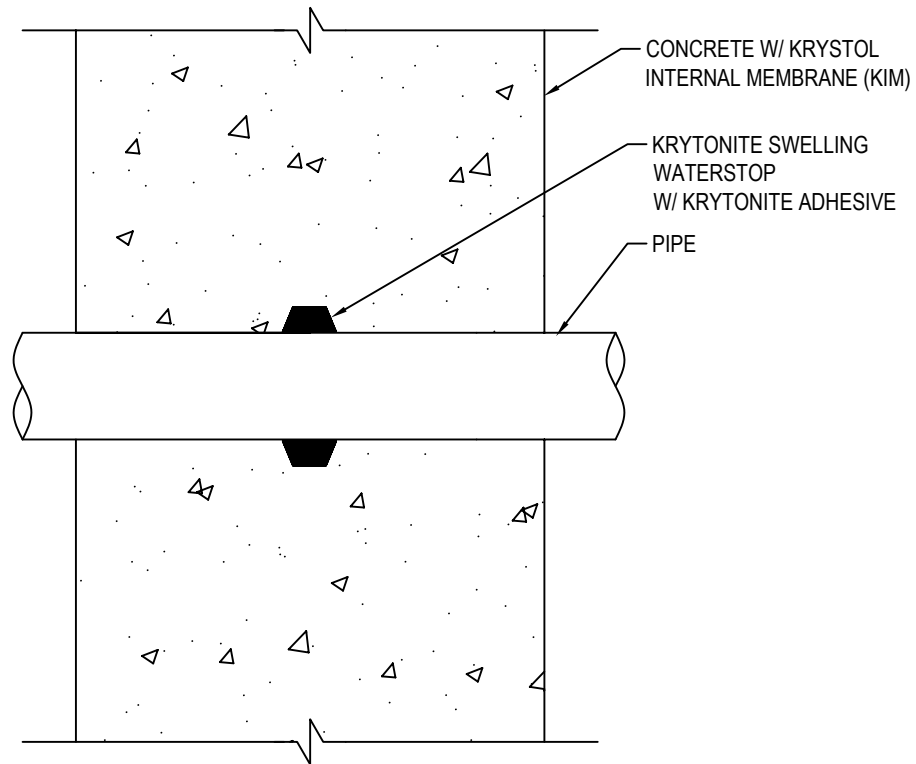

Kryton Buildmat Co. Pvt. Ltd.  
136-137 Centrum Plaza, Golf  
Course Road,  
Sector 53, Gurugram, Haryana  
122002  
Telefax: +91-124-4381140 / 41  
Email: [custcare@kryton.in](mailto:custcare@kryton.in)  
Web: [www.kryton.in](http://www.kryton.in)



PIPE PENETRATIONS  
INTERNAL SWELLING METHOD

**MANUFACTURER'S NOTES:**

1. PLACE CONCRETE TREATED WITH KRYSTOL INTERNAL MEMBRANE (KIM).
2. INSTALL KRYTONITE SWELLING WATERSTOP IN CENTER OF PIPE, USING KRYTONITE ADHESIVE

**NOTES:**

1. INSTALLATION TO BE COMPLETED IN ACCORDANCE WITH MANUFACTURER'S SPECIFICATIONS.
2. DO NOT SCALE DRAWING.
3. THIS DRAWING IS INTENDED FOR USE BY ARCHITECTS, ENGINEERS, CONTRACTORS, CONSULTANTS AND DESIGN PROFESSIONALS FOR PLANNING PURPOSES ONLY. THIS DRAWING MAY NOT BE USED FOR CONSTRUCTION.
4. ALL INFORMATION CONTAINED HEREIN WAS CURRENT AT THE TIME OF DEVELOPMENT BUT MUST BE REVIEWED AND APPROVED BY THE PRODUCT MANUFACTURER TO BE CONSIDERED ACCURATE.

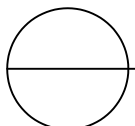

**KRYSTOL WATERSTOP SYSTEM (KWS)**

PIPE PENETRATION - INT SWELLING METHOD